



SUBSURFACE UTILITY ENGINEERING  
FOR CAROLINA CROSSROADS  
I-20 PHASE 3  
EXTENSION



INDEX OF UTILITY SHEETS

UTILITY LEGEND SHEET 2  
UTILITY PLAN SHEETS SHEETS 3-5

UTILITY OWNER INFORMATION

WATER/SEWER		WATER/SEWER	
TOWN OF LEXINGTON ALLEN LUTZ alutz@lexsc.com	FM5	TOWN OF WEST COLUMBIA ANDY AZAENGLE 803-609-2489 azaengle@westcolumbiasc.gov	W2
		*NO RESPONSE, NO RECORDS PROVIDED	
ELECTRIC DOMINION ENERGY PATRICK GIBBONS patrick.gibbons@dominionenergy.com	E1	SCDOT STEVE LITTLEJOHN LittlejoSL@scdot.org	TF1
		*SIZE AND MATERIAL WERE NOT PROVIDED AND IS BASED ON PREVIOUS SUE INVESTIGATION.	
COMMUNICATIONS			
CHARTER COMMUNICATIONS RON WALKER ron.walker@charter.com	TV1		
COMMUNICATIONS			
AT&T NICHOLAS OWENSBY no004k@att.com	T1		
		*SIZE AND MATERIAL NOT PROVIDED AND IS BASED ON FIELD INSPECTION AND PREVIOUS SUE.	
COMMUNICATIONS			
SEGRA JAMES GREGG james.gregg@segra.com	T2		
COMMUNICATIONS			
COMPORIUM Danny Thomas Danny.Thomas@comporium.com	T6		
		*SIZE AND MATERIAL WERE NOT PROVIDED AND IS BASED ON PREVIOUS SUE INVESTIGATION.	
COMMUNICATIONS			
MCI/VERIZON RANDY GILBERT randy.gilbert@verizon.com	T7		
GAS			
DOMINION ENERGY CONSTANCE STROBLE 803-217-4733 constance.stroble@dominionenergy.com	G1		
		*NO RESPONSE, RECORDS PROVIDED BY SCDOT. SIZE AND MATERIAL BASED ON PREVIOUS SUE.	
GAS TRANSMISSION			
DIXIE PIPELINE MARK BURKHALTER mburkhalter@eprod.com	G3		
		*NO RESPONSE, RECORDS PROVIDED BY SCDOT. SIZE AND MATERIAL BASED ON PREVIOUS SUE.	

FED. RD. DIV. NO.	STATE	COUNTY	PROJECT ID	ROAD NO.	SHEET NO.
3	S.C.	LEXINGTON	CCR 00 PH3	I-20	1

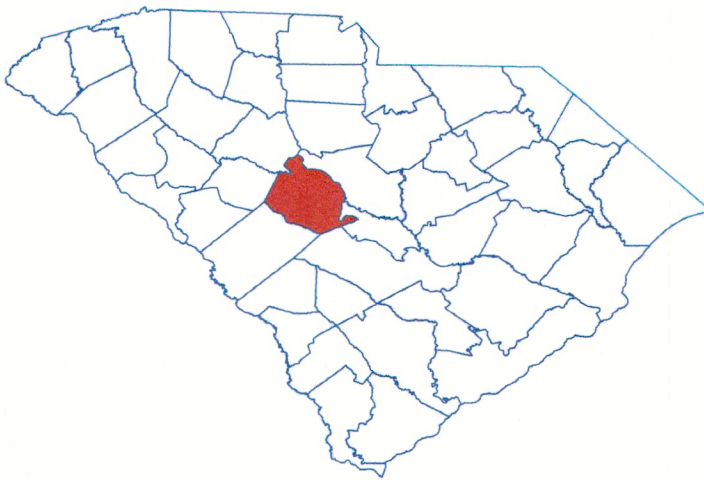

MAP SHOWING LOCATION OF  
LEXINGTON COUNTY IN SOUTH CAROLINA

ESP Associates, Inc.  
2454 N. Center Street  
Suite E-503  
North Charleston  
South Carolina, 29406  
843-714-2040  
www.espassociates.com

NOTE: ALL WORKMANSHIP ON THIS PROJECT  
GENERALLY CONFORMS TO THE STANDARDS  
SET FORTH IN THE LATEST EDITION OF THE  
SCDOT SUBSURFACE UTILITY ENGINEERING  
(SUE) CADD DEVELOPMENT MANUAL.

3 DAYS BEFORE DIGGING  
IN SOUTH CAROLINA

APPROXIMATE LOCATION OF ROADWAY	
LONGITUDE:	-81° 8' 21.6"
LATITUDE :	34° 58' 58.6"

SUBSURFACE UTILITY ENGINEERING FIRM

SUBSURFACE UTILITY ENGINEERING FIRM  
PROJECT ENGINEER

Signature: DATE: 9/18/23

CERTIFICATION STATEMENT:

THESE PLANS WERE PREPARED AND CERTIFIED  
BY THE CONSULTANT FOR COMPLETENESS.  
NO REVIEWS OR SIGNATURES BY THE SCDOT  
ARE REQUIRED.



ucri20ph3ul.dgn



FED. RD. DIV. NO.	STATE	COUNTY	PROJECT ID	ROAD NO.	SHEET NO.
3	S.C.	LEXINGTON	CCR I20 PH3	I-20	3

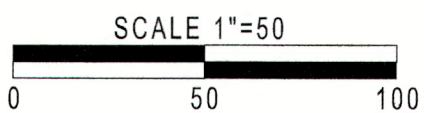
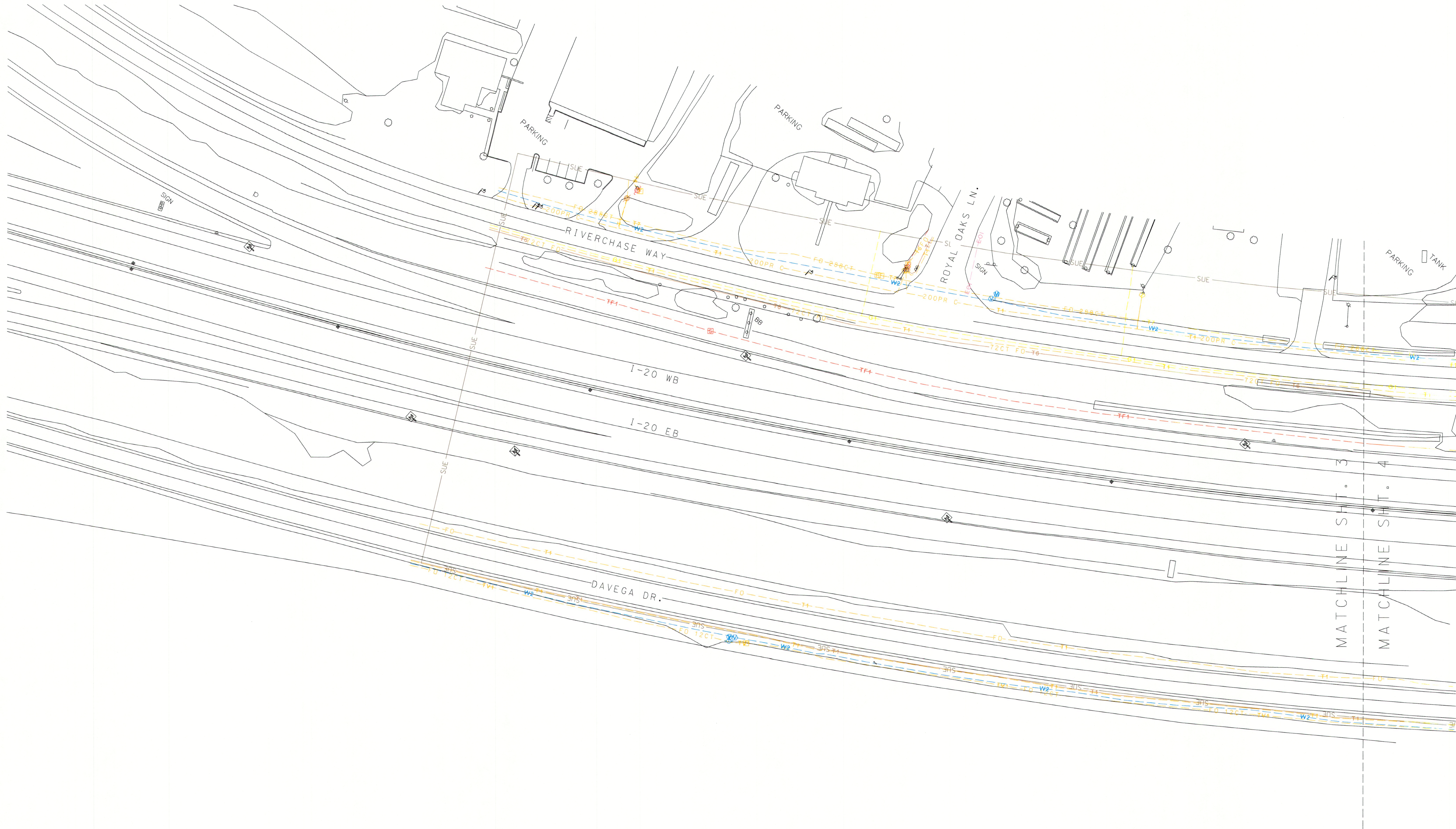
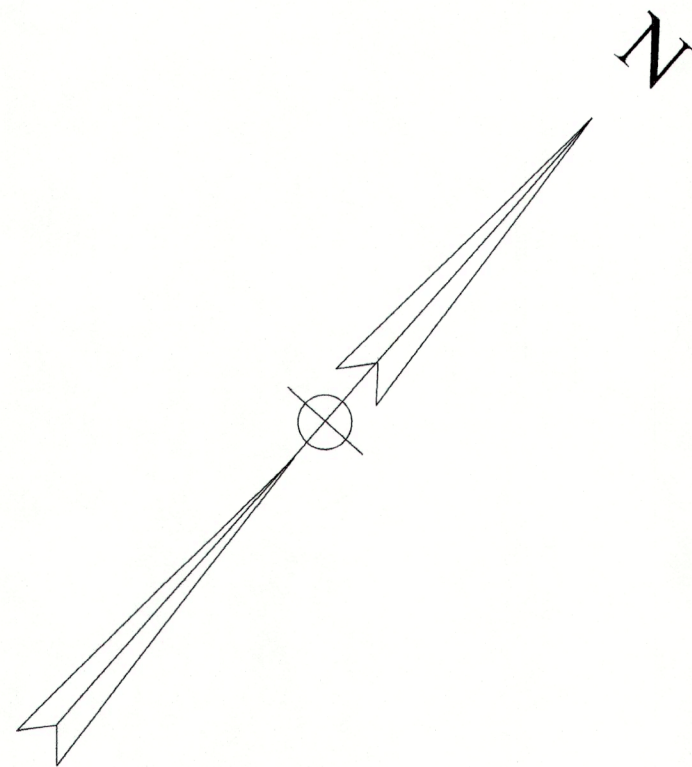

PREPARED FOR:



PREPARED BY:



ESP Associates, Inc.  
2454 N. Center Street  
Suite E-503  
North Charleston  
South Carolina, 29406  
843-714-2040  
www.espassociates.com

4			
3			
2			
1			
REV. NO.	BY	DATE	DESCRIPTION OF REVISION
DRAWN	VSD	9/8/2023	
CHECKED	SDC	9/8/2023	

ESP Associates, Inc.

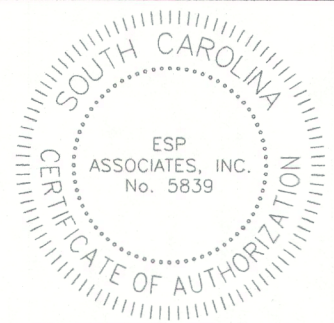
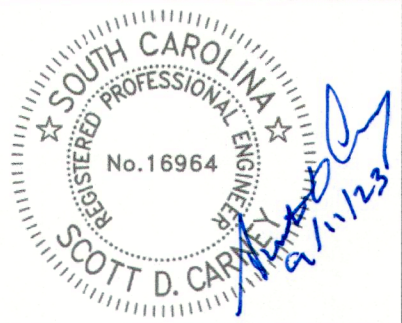

SOUTH CAROLINA  
DEPARTMENT OF TRANSPORTATION  
SUE PLAN SHEET COLUMBIA, SC

CAROLINA CROSSROADS  
I-20 PHASE 3 EXTENSION

SCALE 1"= 50'

uccri20ph3pp.dgn



FED. RD. DIV. NO.	STATE	COUNTY	PROJECT ID	ROAD NO.	SHEET NO.
3	S.C.	LEXINGTON	CCR 20 PH3	I-20	4

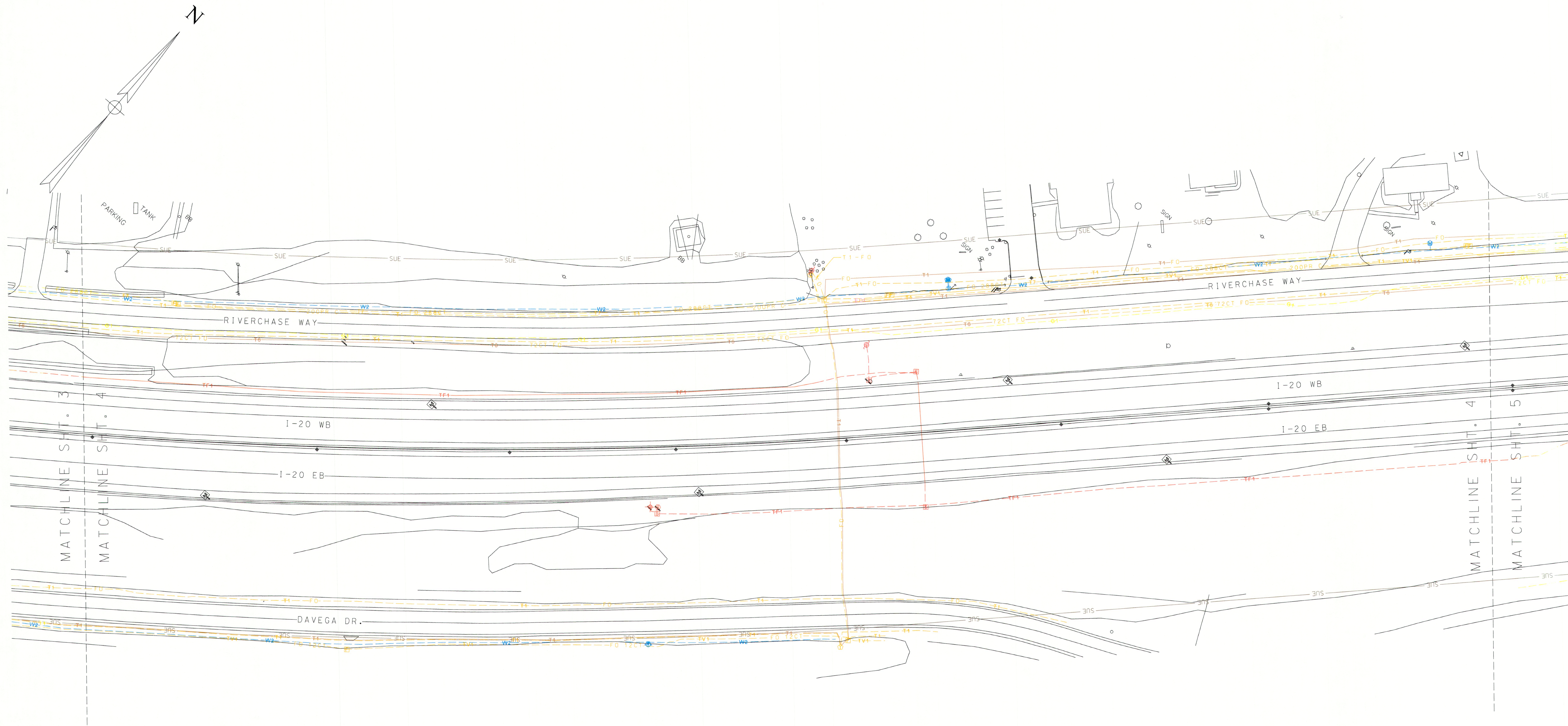

PREPARED FOR:



PREPARED BY:



ESP Associates, Inc.  
2454 N. Center Street  
Suite E-503  
North Charleston  
South Carolina, 29406  
843-714-2040  
www.espassociates.com

REV. NO.	BY	DATE	DESCRIPTION OF REVISION
4			
3			
2			
1			
DRAWN	WSD	9/8/2023	
CHECKED	SDC	9/8/2023	

ESP Associates, Inc.

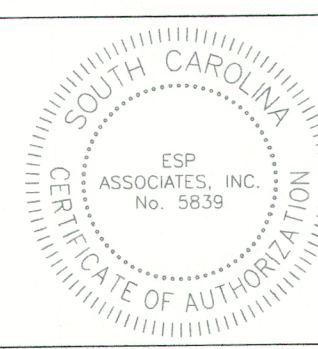
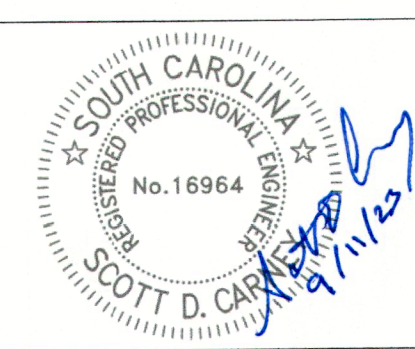

SOUTH CAROLINA  
DEPARTMENT OF TRANSPORTATION  
SUE PLAN SHEET COLUMBIA, SC

CAROLINA CROSSROADS  
I-20 PHASE 3 EXTENSION

SCALE 1"= 50'

uccri20ph3pp.dgn



FED. RD. DIV. NO.	STATE	COUNTY	PROJECT ID	ROAD NO.	SHEET NO.
3	S.C.	LEXINGTON	CCR 120 PH3	I-20	5

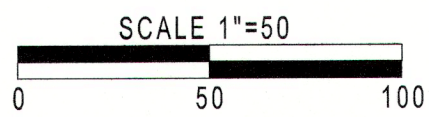
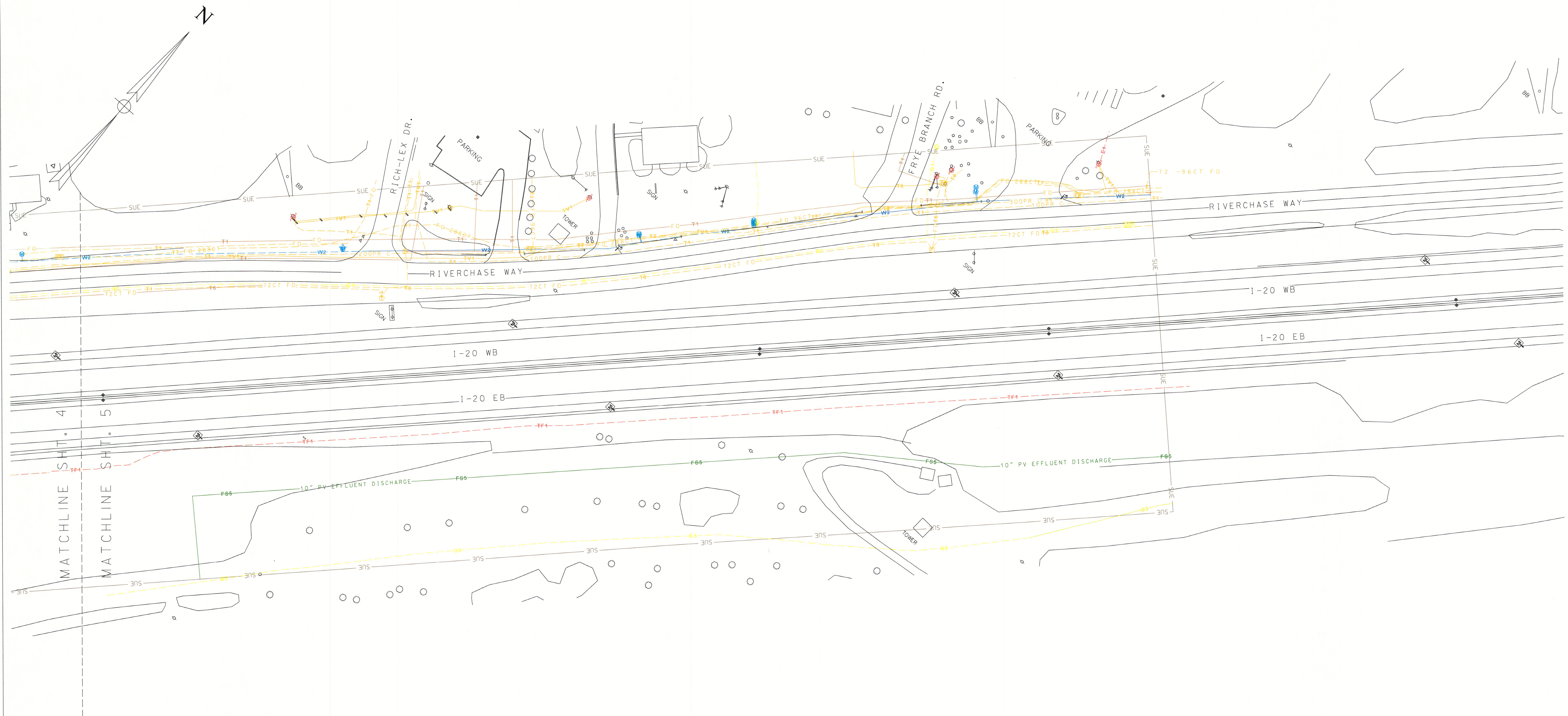

PREPARED FOR:



PREPARED BY:



ESP Associates, Inc.  
2454 N. Center Street  
Suite E-503  
North Charleston  
South Carolina, 29406  
843-714-2040  
www.espassociates.com

REV. NO.	BY	DATE	DESCRIPTION OF REVISION
4			
3			
2			
1			
DRAWN	WSD	9/8/2023	
CHECKED	SDC	9/8/2023	

ESP Associates, Inc.

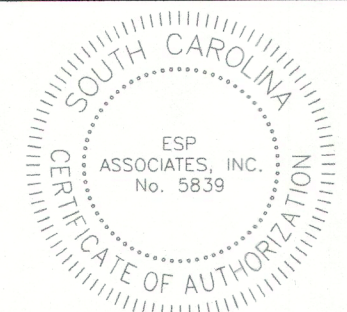
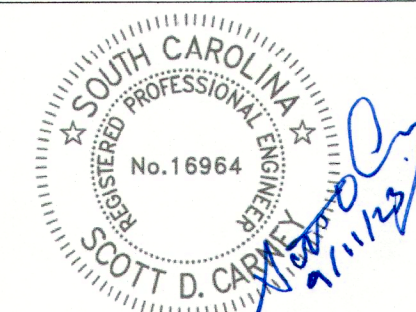

SOUTH CAROLINA  
DEPARTMENT OF TRANSPORTATION  
SUE PLAN SHEET COLUMBIA, SC

CAROLINA CROSSROADS  
I-20 PHASE 3 EXTENSION

SCALE 1"= 50'

uccri20ph3pp.dgn